

INFORMATION

1. THE COVERS ARE DESIGNED TO CLAMP A VINYL SHEET FLOOR FINISH.
2. INSTALLED, THEY GIVE AN AESTHETIC APPEARANCE LEAVING ONLY THE POLISHED PERIMETER EDGE BAR VISIBLE. LOCKABLE AND DOUBLE SEALED.
3. COVERS ARE REMOVED FOR ACCESS BY REPLACING THE HOLDING DOWN BOLTS WITH THE THREADED LIFTING HANDLES SUPPLIED.
4. THE 4300 COVERS ARE SUPPLIED AS INDIVIDUAL OR MULTIPLE UNITS.
5. MULTIPLE COVERS CAN BE USED IN CONJUNCTION WITH A STAINLESS STEEL CHANNEL TO FORM A CONTINUOUS DUCT.
6. LOADING CAPACITIES ARE PEDESTRIAN. SPECIALLY DESIGNED HEAVY-DUTY COVERS ARE AVAILABLE ON REQUEST.
7. AVAILABLE IN GRADE 304 OR 316 STAINLESS STEEL.

MATERIAL SPECIFICATION:

STAINLESS STEEL - GRADE 304 (BS 1449:PART 2:1983) 1.4301 (BS EN 10088-1:1995)
 STAINLESS STEEL - GRADE 316 (BS 1449:PART 2:1983) 1.4436 (BS EN 10088-1:1995) - ALTERNATIVE OPTION

INSTALLATION INSTRUCTIONS

1. CAREFULLY UNLOAD THE ASSEMBLED COVER AND REMOVE PACKAGING MATERIAL.
2. FIT THE PROFILED OUTER FRAME (ITEM 4) OVER THE MANHOLE AND ADJUST TO FINISHED SCREED LEVEL.
3. FIX AND BED-IN THE PROFILED OUTER FRAME.
4. DRAW THE FLOORING OVER THE ANGLED PORTION OF THE PROFILED FRAME (AS DETAILED BELOW) AND HOLD IN POSITION BY DROPPING IN THE SMALLER CLAMPING FRAME (ITEM 3) APPLYING SEALANT BETWEEN THE TWO MATING FACES (AS DETAILED BELOW).
5. BOLT THE CLAMPING FRAME (ITEM 3) TO THE PROFILED OUTER FRAME (ITEM 4) SECURING THE FLOORING BETWEEN THE TWO, AS DETAILED ABOVE.

IMPORTANT: CARE MUST BE TAKEN THAT ALL FIXINGS ARE NOT OVERTIGHTEND - THE TORQUE REQ'D SHOULD BE NOTHING MORE THAN A 'NIP'. OVERTIGHTENING WILL RESULT IN THE SOCKET SPINNING & THE COVER BECOMING NON-REMOVABLE.

6. ASSEMBLE THE LID BY COVERING THE BACKING PLATE (ITEM 1) WITH FLOORING MATERIAL AND CLAMPING AT THE EDGES WITH THE STAINLESS STEEL TRIM ASSEMBLY (ITEM 2), FINALLY FIXING THE FASCIA TRIM. (TOP SECTION - ITEM 2).
7. THE COMPLETED LID IS NOW SCREWED DOWN IN POSITION WITH THE COUNTERSUNK HEXAGONAL SOCKET HEAD SCREWS, (UNLESS ALTERNATIVE FIXINGS ARE SPECIFIED).
8. ENSURE VINOSEAL COVERS ARE ADEQUATELY PROTECTED AGAINST POSSIBLE DAMAGE RESULTING FROM THE CONTINUATION OF WORK IN THE AREA.
9. IMMEDIATELY BEFORE HANDOVER OF THE BUILDING REMOVE THE PROTECTIVE PEEL-OFF STRIPS FROM THE TRIM.

DATA SHEET

TYPE 4300

**STAINLESS STEEL
VINOSEAL MANHOLE COVER**

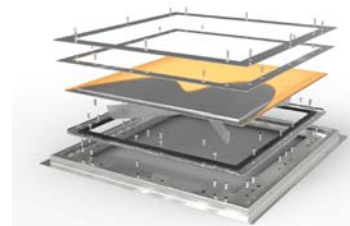
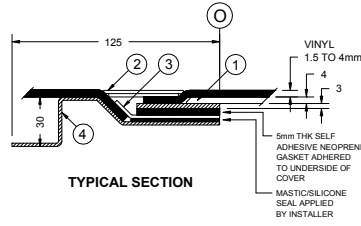

CONTACT DETAILS:

COMPONENT DEVELOPMENTS

**HALESFIELD 10
TELFORD
SHROPSHIRE
TF7 4QP**

**T: 01952 588488
F: 01952 684395**

**E-MAIL: info@componentdevelopments.com
WEBSITE: www.componentdevelopments.com**

APPROXIMATE WEIGHT:

COVER & FRAME ASS'Y (NO VINYL INFILL):
600 x 600mm C/O = 40kg

COVER ONLY
(C/W VINYL CLAMPED IN POSITION):
600 x 600mm C/O = 29kg

PLEASE NOTE: ALL LIFTING OF COVERS SHOULD BE UNDERTAKEN FOLLOWING CURRENT HEALTH & SAFETY LEGISLATION PRACTISES.

REPLACEMENT PARTS:

PLEASE CONTACT US DIRECTLY FOR ALL REPLACEMENT PARTS. FULL TECHNICAL ASSISTANCE CAN BE PROVIDED.

